

vtech[®]

Instruction Manual

Rock & Bop Music Player™ Pro



INTRODUCTION

Explore and learn with the cute animated character on the **Rock & Bop Music Player™ Pro** by VTech®! Enjoy fun interactive games, music and relaxing activities with included kid-safe headphones! Let's jam!



- | | |
|----------------------------|---------------------|
| ① Headphones | ⑪ Chill Zone |
| ② On/Off Button | ⑫ Dance Party |
| ③ Learning Songs | ⑬ LCD Screen |
| ④ Jazz Music | ⑭ Classical Music |
| ⑤ Rock Music | ⑮ Pop Music |
| ⑥ Instrument Remix | ⑯ Sneaky Notes |
| ⑦ Catch the Rhythm | ⑰ Play/Pause Button |
| ⑧ Previous Button | ⑱ Next Button |
| ⑨ Light Button | |
| ⑩ Volume Button (5 Levels) | |

INCLUDED IN THIS PACKAGE

- Rock & Bop Music Player™ Pro
- Headphones
- Quick Start Guide

WARNING

All packing materials such as tape, plastic sheets, packaging locks, removable tags, cable ties, cords and packaging screws are not part of this toy and should be discarded for your child's safety.

NOTE

Please save this Instruction Manual as it contains important information.

ATTENTION :

Pour la sécurité de votre enfant, débarrassez-vous de tous les produits d'emballage tels que rubans adhésifs, feuilles de plastique, attaches, étiquettes, cordons et vis d'emballage. Ils ne font pas partie du jouet.

NOTE :

Il est conseillé de sauvegarder ce manuel d'utilisation car il comporte des informations importantes.

Unlock the packaging locks:

- ① Turn the packaging lock 90 degrees counterclockwise several times.
- ② Pull out and discard the packaging lock.

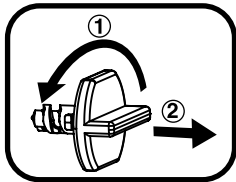

INSTRUCTIONS

Note:

In order to protect your child's hearing, the volume level of the headphones is lower than the speaker.



WARNING:

Adult assembly required for battery installation.

Keep batteries out of reach of children.



ATTENTION :

Les piles ou accumulateurs doivent être installés par un adulte.

Tenir les piles ou accumulateurs hors de portée des enfants.

BATTERY REMOVAL AND INSTALLATION

1. Make sure the unit is turned **OFF**.
2. Find the battery cover located on the back of the unit, use a screwdriver to loosen the screw and then open the battery cover.
3. Remove old batteries by pulling up on one end of each battery.
4. Install 2 new AAA (LR03/AM-4) batteries following the diagram inside the battery box. (For best performance, alkaline batteries or fully charged Ni-MH rechargeable batteries are recommended.)
5. Replace the battery cover and tighten the screw to secure

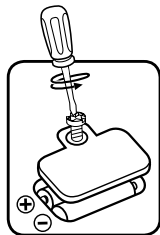

IMPORTANT: BATTERY INFORMATION

- Insert batteries with the correct polarity (+ and -).
- Do not mix old and new batteries.
- Do not mix alkaline, standard (carbon-zinc) or rechargeable batteries.

- Only batteries of the same or equivalent type as recommended are to be used.
- Do not short-circuit the supply terminals.
- Remove batteries during long periods of non-use.
- Remove exhausted batteries from the toy.
- Dispose of batteries safely. Do not dispose of batteries in fire.

RECHARGEABLE BATTERIES:

- Remove rechargeable batteries (if removable) from toy before charging.
- Rechargeable batteries are only to be charged under adult supervision.
- Do not charge non-rechargeable batteries.

Product Features

1. On/Off Button

Press the **On/Off Button** to turn the unit **On**. Press the **On/Off Button** again to turn the unit **Off**.

2. Function Buttons

A) Play/Pause Button

Play or pause the music by pressing the **Play/Pause Button**.

B) Previous Button and Next Button

Press the **Previous Button** or **Next Button** to make a selection.

C) Light Button

Press the **Light Button** to turn the backlight and LEDs **On/Off**.

D) Volume Button

Press the **Volume Button** to adjust the volume.

3. Ten Activity Buttons

Press the **Activity Buttons** to play different games and music.

4. **Automatic Shut-Off**

To preserve battery life, the unit will automatically power-off after several minutes without input. The unit can be turned **On** again by pressing the **On/Off Button**.

ACTIVITIES

1. **Learning Songs**

Hear a variety of songs about letters, numbers, washing hands and more! Press the **Previous** or **Next Buttons** to select different songs.

2. **Dance Party**

Get up and dance with some boogie tunes.

3. **Chill Zone**

Listen to calming breathing activities that help children unwind and relax. You can select the Balloon Blowing activity to exercise steady breathing, or Quiet Time to listen to meditation music for a moment of calm.

4. **Rock Music**

Listen to rock music and press the **Previous** or **Next Buttons** to select a different song or melody.

5. **Jazz Music**

Listen to jazz music and press the **Previous** or **Next Buttons** to select a different song or melody.

6. **Classical Music**

Listen to classical music and press the **Previous** or **Next Buttons** to select a different song or melody.

7. Pop Music

Listen to pop music and press the **Previous** or **Next Buttons** to select a different song or melody.

8. Catch the Rhythm

Challenge yourself to follow the rhythm and catch it. Press the correct button when the falling bar touches the icon to catch the rhythm!

9. Instrument Remix

Explore fun melodies and swap the instruments by pressing the **Previous** or **Next Buttons**!

10. Sneaky Notes

Collect the various sneaky notes as they appear on screen at random!

SONG LYRICS

SONG 1

Dance! Dance! Everybody dance!
Listen to the beat and get off your feet!

SONG 2

Scrub, Scrub, Scrub! I'm gonna wash my hands!
Soapy, Soapy, Suds! Oh yeah that's the plan!
The water is warm and the bubbles are poppin'!
Washing my hands with the music boppin'!

SONG 3

You can be anything you wanna be!
Believe in yourself and follow your dreams!
Just try your best and never give up!
Your dreams can become reality!

SONG 4

If a mistake is made, it's OK.
Sometimes lessons are learned this way.
Practice makes perfect, be patient and kind.
Because we all make mistakes from time to time.

SONG 5

There was a farmer who had a dog,
And Bingo was his name - O.
B-I-N-G-O!
B-I-N-G-O!
B-I-N-G-O!
And Bingo was his name - O.
There was a farmer who had a dog,
And Bingo was his name - O.
B-I-N-G-O!
B-I-N-G-O!
B-I-N-G-O!
And Bingo was his name - O.

SONG 6

One, two,
Buckle my shoe!
Three, four,
Knock at the door!
Five, six,
Pick up sticks!
Seven, eight,
Lay them straight!
Nine, ten,
Let's do it all again!

SONG 7

A - B - C - D - E - F - G
H - I - J - K - L - M - N - O - P
Q - R - S
T - U - V

W - X

Y and Z

Now I know my A - B - C's

Next time won't you sing with me?

SONG 8

Clap, Clap, Clap your hands!

Stomp, Stomp, Stomp your feet!

Wiggle, Wiggle, Wiggle all around!

Jump, Jump, Jump off the ground!

Whoaaa! Whoaaa! This is our song!

Whoaaa! Whoaaa! Party all day long!

Wave, Wave, Wave your arms!

Shake, Shake, Shake your legs!

Jiggle, Jiggle, Jiggle all around!

Bounce, Bounce, Bounce off the ground!

Whoaaa! Whoaaa! This is our song!

Whoaaa! Whoaaa! Party all day long!

Whoaaa! Whoaaa! This is our song!

Whoaaa! Whoaaa! Party all day long!

SONG 9

Boogie, Boogie, Boogie! Shake and spin!

Woogie, Woogie, Woogie! Twist and jump!

Boogie, Boogie, Boogie! Hop and skip!

Woogie, Woogie, Woogie! Hands on hips!

And Freeze!

SONG 10

Bounce! Bounce! Raise your hands up!

Bounce! Bounce! Never give up!

Jump up! Jump far! And reach for the sky!

Jump up! Jump far! Let's touch the stars!

CARE & MAINTENANCE

1. Keep the unit clean by wiping it with a slightly damp cloth.
2. Keep the unit out of direct sunlight and away from any direct heat sources.
3. Remove the batteries if the unit will not be in use for an extended period of time.
4. Do not drop the unit on hard surfaces and do not expose the unit to moisture or water.

TROUBLESHOOTING

If for some reason the program/activity stops working or malfunctions, please follow these steps:

1. Please turn the unit **Off**.
2. Interrupt the power supply by removing the batteries.
3. Let the unit stand for a few minutes, then replace the batteries.
4. Turn the unit **On**. The unit should now be ready to play with again.
5. If the unit still does not work, install a brand new set of batteries.

IMPORTANT NOTE

If the problem persists, please call our **Consumer Services Department** at **1-800-521-2010** in the U.S., **1-877-352-8697** in Canada, or visit our website **vtechkids.com** and fill out our **Contact Us** form located under the **Customer Support** link. Creating and developing VTech products is accompanied by a responsibility that we take very seriously. We make every effort to ensure the accuracy of the information, which forms the value of our products. However, errors sometimes can occur. It is important for you to know that we stand behind our products and encourage you to contact us with any problems and/or suggestions you might have. A service representative will be happy to help you.

NOTE

This equipment has been tested and found to comply with the limits for a Class B digital device, pursuant to Part 15 of the FCC Rules. These limits are designed to provide reasonable protection against harmful interference in a residential installation. This equipment generates, uses and can radiate radio frequency energy and, if not installed and used in accordance with the instructions, may cause harmful interference to radio communications. However, there is no guarantee that interference will not occur in a particular installation. If this equipment does cause harmful interference to radio or television reception, which can be determined by turning the equipment off and on, the user is encouraged to try to correct the interference by one or more of the following measures:

- Reorient or relocate the receiving antenna.
- Increase the separation between the equipment and receiver.
- Connect the equipment into an outlet on a circuit different from that to which the receiver is connected.
- Consult the dealer or an experienced radio/TV technician for help.

CAUTION

Changes or modifications not expressly approved by the party responsible for compliance could void the user's authority to operate the equipment.

Supplier's Declaration of Conformity
47 CFR § 2.1077 Compliance Information

Trade Name: VTech®
Model: 5692
Product Name: Rock & Bop Music Player™ Pro
Responsible Party: VTech Electronics North America, L.L.C.
Address: 1156 W. Shure Drive, Suite 200
Arlington Heights, IL 60004
Website: vtechkids.com

THIS DEVICE COMPLIES WITH PART 15 OF THE FCC RULES. OPERATION IS SUBJECT TO THE FOLLOWING TWO CONDITIONS: (1) THIS DEVICE MAY NOT CAUSE HARMFUL INTERFERENCE, AND (2) THIS DEVICE MUST ACCEPT ANY INTERFERENCE RECEIVED, INCLUDING INTERFERENCE THAT MAY CAUSE UNDESIRED OPERATION.

**Visit our website for more
information about our products,
downloads, resources and more.**

vtechkids.com
vtechkids.ca

Read our complete warranty policy online at
vtechkids.com/warranty
vtechkids.ca/warranty

